



Spectrum WiFi 5 Wave 2 Router

User Guide - Version 6





Spectrum WiFi Router with Advanced WiFi

Advanced WiFi on the Spectrum WiFi router delivers internet, network security and personalization, conveniently managed with the My Spectrum app. Your router will have QR code on the back label to indicate support of this service.

Advanced WiFi Features

With Advanced WiFi, you can:

- Personalize your WiFi network name and password.
- Pause or resume WiFi access for a device connected to your WiFi network.
- Get port forwarding support for improved gaming performance.
- Have peace of mind with a secure WiFi network.
- Use both wireless and Ethernet connectivity.

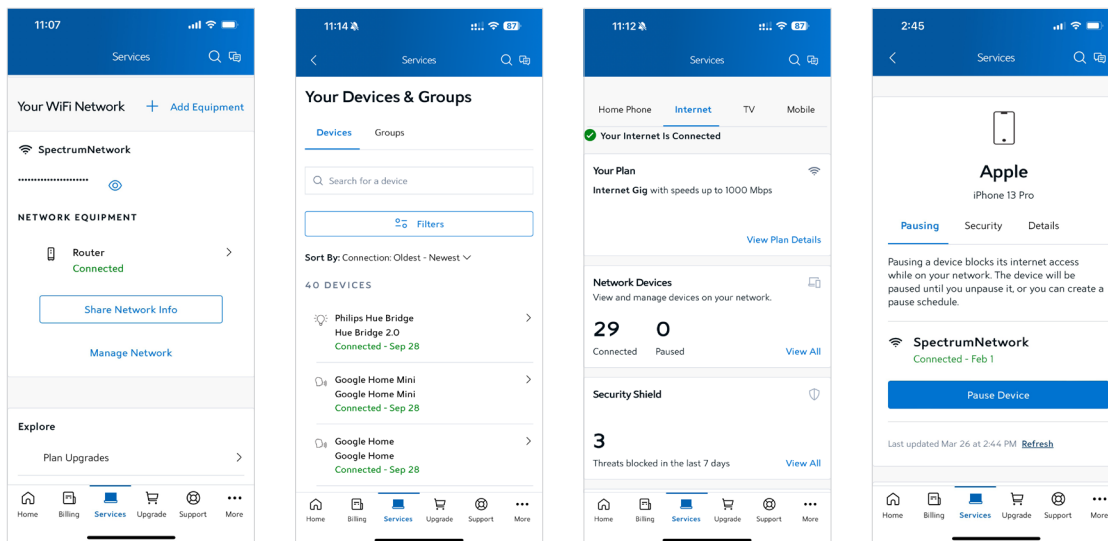

Get Started with My Spectrum App
Scan the QR code with your smartphone camera
or visit spectrum.net/getappnow



Free on iPhone and Android

After downloading, sign in with your Spectrum username and password.

Don't have a Spectrum username? [Spectrum.net](https://spectrum.net) and select **Create a Username**.

Personalize Your WiFi Network Name and Password

To secure your home network, we recommend creating a unique network name and a password containing letters and numbers. You can change your network name and password on Spectrum.net or in the [My Spectrum App](#).

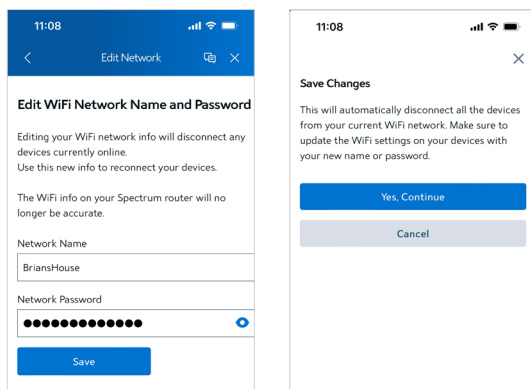

Troubleshooting Your Internet Service

If you're experiencing slow speeds or if you lose connection to your WiFi network, try the following:

- 1. Move closer to the router:** The farther away you are, the weaker the signal will be.
- 2. Adjust router location:** Your router should be placed in a central location for the best coverage.
- 3. Restart your router:** Restarting your router solves most problems, whether you have a slow connection or no internet at all.

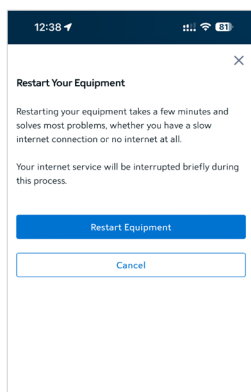

Place your Router for the Best Coverage

- Personalize your WiFi network name and password.
- Do place in a central location.
- Do place on a raised surface.
- Do place in an open space.
- Don't place in a media center or closet.
- Don't place near devices like cordless phones that emit wireless radio signals.
- Don't place behind a TV.

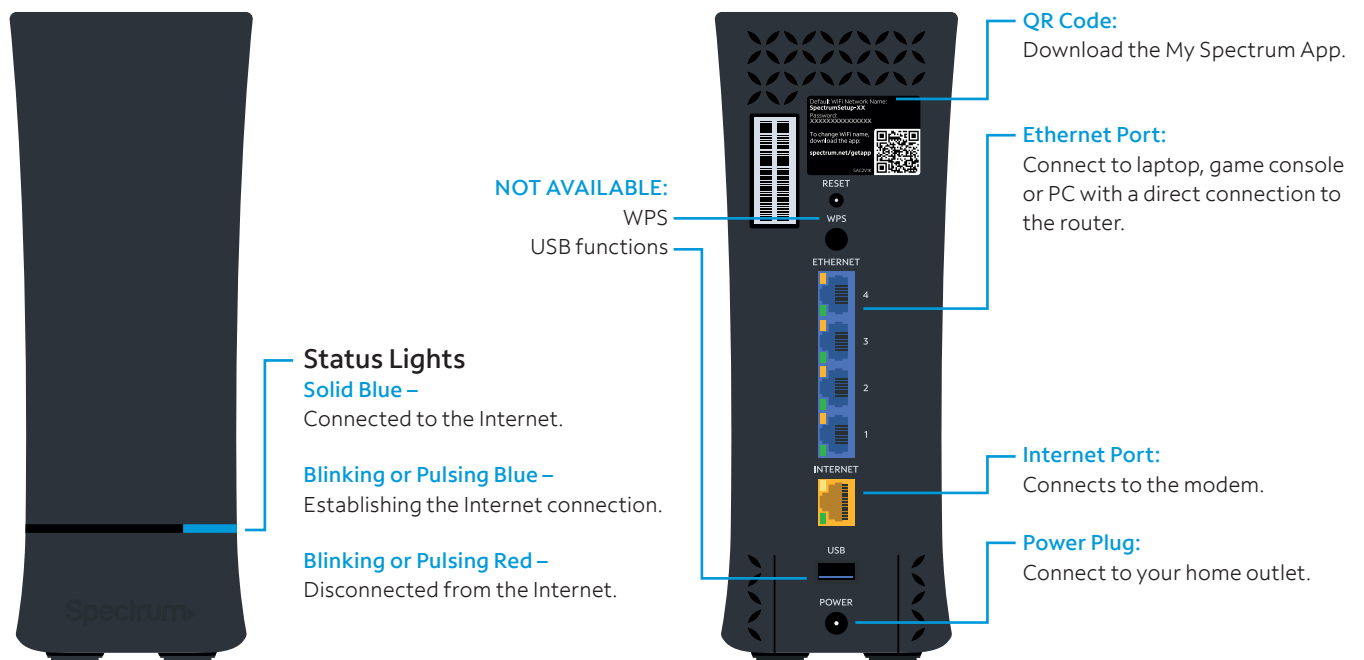

Technical Specs

Features	Benefits
Concurrent 2.4 GHz and 5 GHz frequency bands	Supports existing client devices in the home, and all newer devices using higher frequencies. Provides flexibility in range for WiFi signal to cover the home.
3 to 4 Tx / Rx antenna for each frequency band with up to 4 logical data streams	Higher throughput and increased range provide improved experience. Delivers higher data rates for the 2.4 GHz and 5 GHz frequencies.
802.11ac wave 2 WiFi chipsets with higher processing power.	Supports consistent performance and higher density of WiFi devices connecting to the network.
Industry-standard security (WPA2 personal)	Supports the industry security standard to protect devices on the WiFi network.
Four GigE LAN ports	Connect stationary computers, game consoles, printers, media sources and other devices on the private network for high-speed service.
More specs	Radio support: 2.4 GHz 3x3 b/g/n 5 GHz 4x4 a/n/ac Ethernet standard: 10/100/1000 IPv4 and IPv6 support Power supply: 12VDC/2.5A Dimensions: 4" x 3.5" x 9"

Need Help or Have Questions?

We're here for you. To learn more about your services or get support, visit spectrum.net/support or call us at [\(855\) 632-7020](tel:8556327020).

Federal Communication Commission Interference Statement

This device complies with Part 15 of the FCC Rules. Operation is subject to the following two conditions: (1) This device may not cause harmful interference, and (2) this device must accept any interference received, including interference that may cause undesired operation.

This equipment has been tested and found to comply with the limits for a Class B digital device, pursuant to Part 15 of the FCC Rules. These limits are designed to provide reasonable protection against harmful interference in a residential installation. This equipment generates, uses and can radiate radio frequency energy and, if not installed and used in accordance with the instructions, may cause harmful interference to radio communications. However, there is no guarantee that interference will not occur in a particular installation. If this equipment does cause harmful interference to radio or television reception, which can be determined by turning the equipment off and on, the user is encouraged to try to correct the interference by one of the following measures:

- Reorient or relocate the receiving antenna.
- Increase the separation between the equipment and receiver.
- Connect the equipment into an outlet on a circuit different from that to which the receiver is connected.
- Consult the dealer or an experienced radio/TV technician for help.

FCC Caution: Any changes or modifications not expressly approved by the party responsible for compliance could void the user's authority to operate this equipment.

This transmitter must not be co-located or operating in conjunction with any other antenna or transmitter.

This device meets all the other requirements specified in Part 15E, Section 15.407 of the FCC Rules.

Radiation Exposure Statement:

This equipment complies with FCC radiation exposure limits set forth for an uncontrolled environment. This equipment should be installed and operated with minimum distance 20cm between the radiator & your body.

Note: The country code selection is for non-US model only and is not available to all US model. Per FCC regulation, all WiFi product marketed in US must be fixed to US operation channels only.

FCC regulations restrict the operation of this device to indoor use only.

- a. The operation of this device is prohibited on oil platforms, cars, trains, boats, and aircraft, except that operation of this device is permitted in large aircraft while flying above 10,000 feet.